

DelTorq[®] SERIES 25

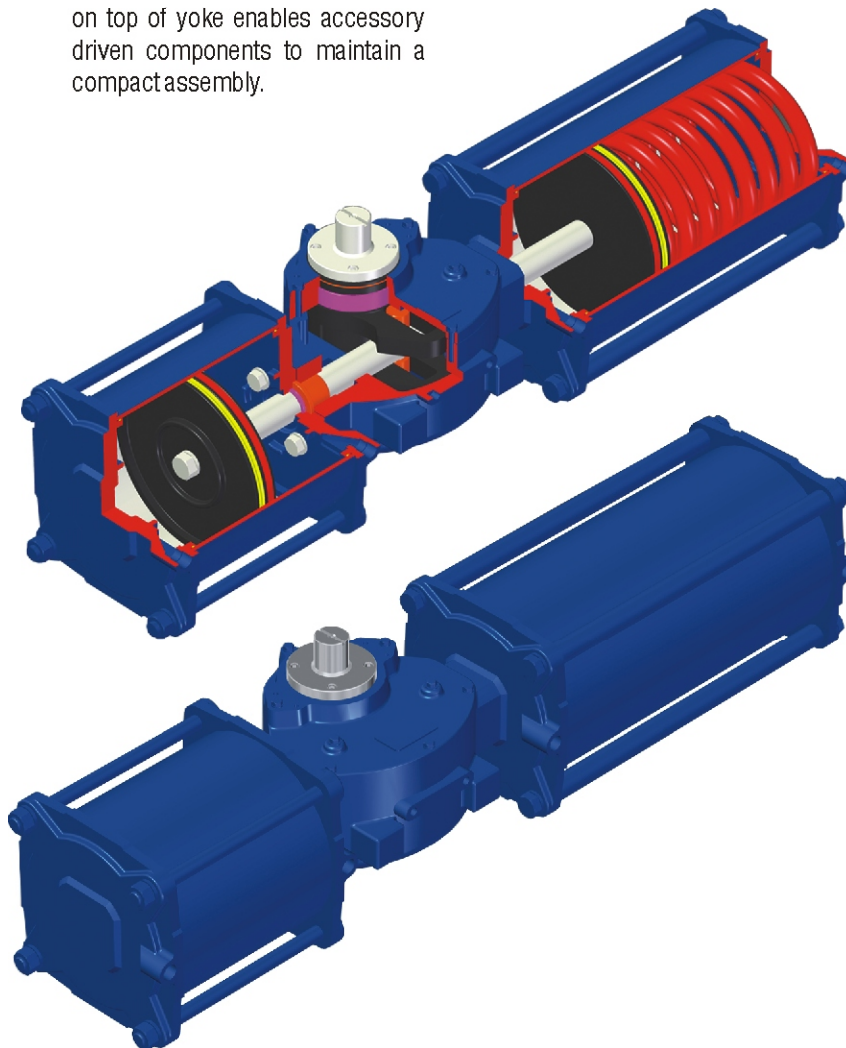

Pneumatic Scotch Yoke Actuator

- ▶ Ductile iron housing, chrome plated steel cylinders and steel end-caps.
- ▶ Cylinder bore is chrome plated then honed to provide the ultimate in corrosion resistance and increased piston performance.
- ▶ Compact design utilizing a unique two(2) piston design.
- ▶ "Safe Spring" design allows the actuator to be safely assembled and disassembled in the field without the need for special tools. Design consists of high strength tie rods drilled and tapped at both ends to provide for the loading and unloading of the spring in a safe manner.
- ▶ Chrome plated steel piston rod provides strength and corrosion resistance for enduring high cycle applications.
- ▶ Heat treated stainless steel thrust pin transfers piston force to the steel yoke for efficient transmission of torque.
- ▶ Guide bands and piston cup seals ensure low-friction piston guidance during operation to protect cylinder walls from potential scoring and provides continuous cylinder wiping action.
- ▶ Spring return actuators are pre-piped with stainless steel tubing to provide air to both pistons with one single connection.
- ▶ ISO 5211 mounting pattern provides easy valve / actuator mounting using international standards.
- ▶ Unique hollow yoke design permits the use of a universal adapter for direct mounting to quarter turn valves.
- ▶ Top cover drilled to NAMUR standards. Namur drive slot in shaft on top of yoke enables accessory driven components to maintain a compact assembly.
- ▶ Sintered bronze piston rod bushing provides low-friction support and precise alignment of the piston rod to increase efficiency. It also provides extended actuator life and efficient torque transmission.
- ▶ Bi-directional travel stop located in the main housing to provide adjustment in open and closed direction +/- 5 degrees.



How to Order

Series	Size		Operation	Trim / Other Variables / Specials			
□□	□□□	□□	□□	□	□	□□□	□□
Series	Housing	Cylinder	Pressure Connection	Spring Pressure Rating	Shaft Rotation	Insert Size	Special Options
25 = Scotch Yoke Actuator	250 = 2.5" Yoke Arm *325 = 3.25" Yoke Arm	06 = 6" Ø 07 = 7" Ø 08 = 8" Ø 09 = 9" Ø 10 = 10" Ø 11 = 11" Ø 12 = 12" Ø	SR = Spring Return DA = Double Acting	000 = For DA Actuators 060 = Rated for 60 PSI 080 = Rated for 80 PSI 100 = Rated for 100 PSI 125 = Rated for 125 PSI 150 = Rated for 150 PSI	C = Fail Clockwise Direction (Standard for SR) F = Fail Counter Clockwise Direction S = Standard for Double Acting Models Y = Reverse Acting for Double Acting Models	*** Please see "Insert Codes" page for available inserts. Insert size determines female size of pinion	00 = No special requirements (Ductile iron housing, chrome plated steel cylinder and steel end caps) SS = Stainless steel housing, cylinder and end caps
* Available Soon							

Engineering (Inch)

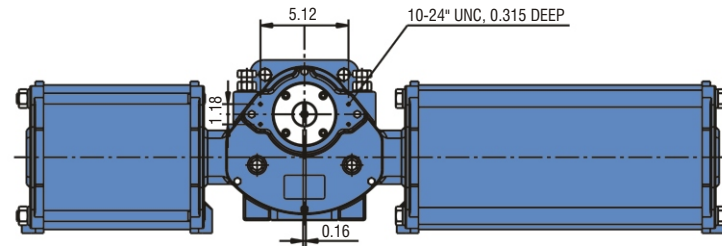
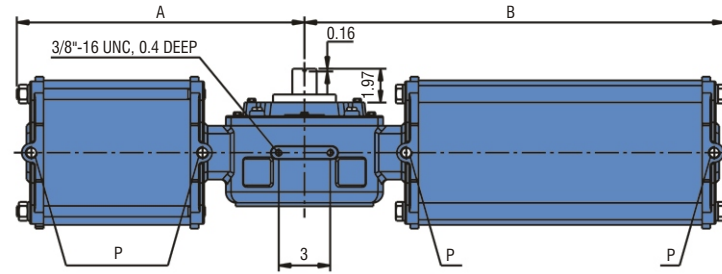
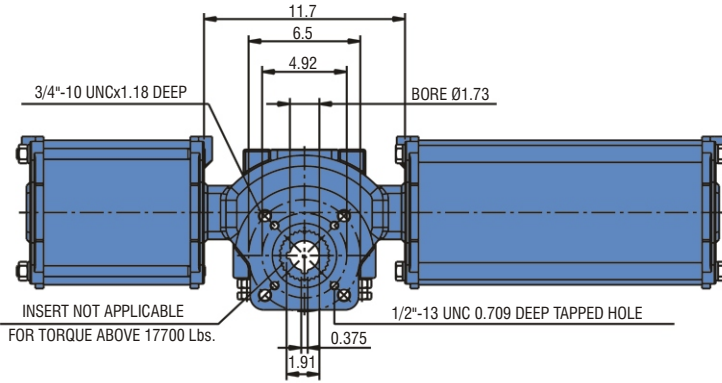

Dimensions (Inch)

MODEL	A	B					C	D	P
		DA	SR 40	SR 60	SR 80	SR 100			
250-06	16.34	16.34	19.1	20.67	22.24	25.2	6.81	9.05	1/4"NPT
250-07	16.53	16.53	19.68	22.24	22.05	24.80	7.87	9.61	1/4"NPT
250-08	16.73	16.73	20.27	22.05	22.44	24.61	8.82	10.06	3/8"NPT
250-10	17.44	17.44	22.05	23.03	23.62	23.62	10.83	11.06	3/8"NPT

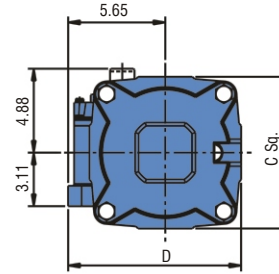

Double Acting Torques (Lb -Inch)

MODEL	TORQUE (Lb-Inch)	AIR SUPPLY PRESSURE (Psi)			
		40	60	80	100
250-06	BREAK	7310	10965	14620	18284
	RUN	4779	7169	9558	11956
250-07	BREAK	10027	15045	20054	25072
	RUN	6558	9832	13116	16390
250-08	BREAK	13045	19567	26081	32603
	RUN	8531	12788	17054	21320
250-10	BREAK	20417	30630	40834	-
	RUN	13355	20028	26700	-

MODEL	Weight in (Lb)				
	DA	SR 40	SR 60	SR 80	SR 100
250-06	121	136.5	143	154	171.6
250-07	143	169.5	176	187	198
250-08	165	202.5	209	220	255.2
250-10	253	312.5	319	330	334.5

VOLUME (Inch ³)
380
432
682
1053

Spring Return Torques (Lb -Inch)

MODEL	TORQUE (Lb-Inch)	AIR SUPPLY PRESSURE (Psi)			
		40	60	80	100
250-06	PB	4921	7381	9841	12293
	PE	2735	4098	5460	6823
	SB	4699	7053	9408	11753
	SE	2611	3912	5222	6522
	RUN	1965	2956	3938	4921
250-07	PB	6744	10116	13487	16859
	PE	3744	5620	7487	9363
	SB	6452	9673	12894	16116
	SE	3584	5372	7160	8947
	RUN	2699	4053	5399	6753
250-08	PB	8770	13160	17550	21930
	PE	4868	7310	9744	12178
	SB	8390	12576	16771	20966
	SE	4655	6983	9310	11638
	RUN	3513	5266	7027	8779
250-10	PB	13735	20603	27470	34338
	PE	7629	11443	15249	19063
	SB	13133	19691	26258	32825
	SE	7292	10939	14576	18222
	RUN	5496	8248	10992	13744



DelTech Controls LLC

6068 Highway 73
Geismar, LA 70734
USA
Phone: (225) 744-4326
Fax: (225) 744-4328
Email : sales@deltechcontrols.com

DelVal Oilfield Sales, LLC

217 Industrial Pkwy.
Lafayette, LA 70508
USA
Phone: (337) 456-4979
Fax : (337) 456-6564
E-mail: dos@deltechcontrols.com